

(Endorsement on Back)

Reserved Tract at
Presque Isle
3035²³ & 1112
Received and read in Council
Septem^r 15th 1789 1st time

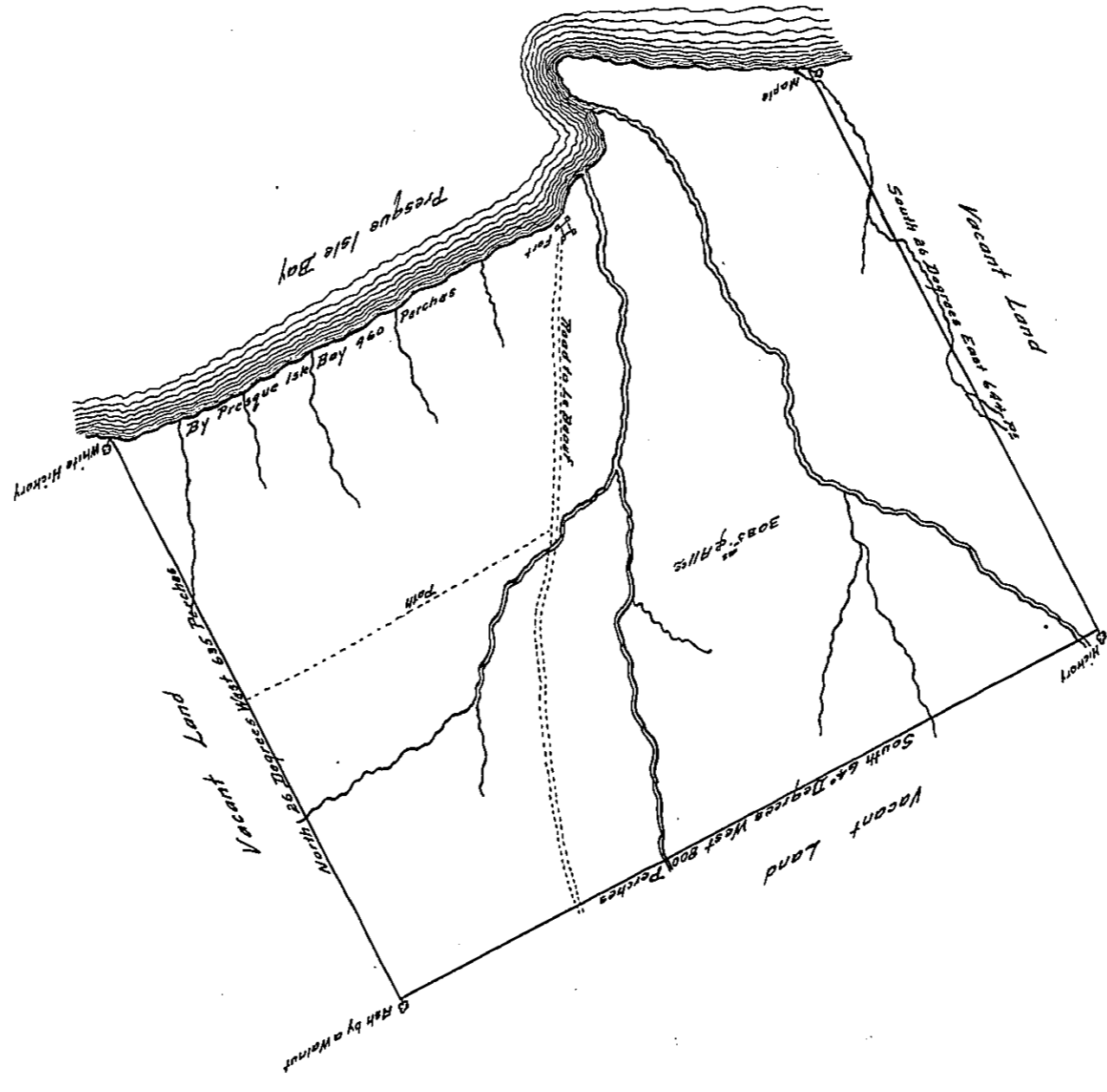

In pursuance of a Resolve of the General Assembly dated the 24th of March 1789 and by order of the Surveyor General, was surveyed on the 27th 28th & 29th days of July A.D. 1789 the Above described Tract of Land, Situate at Presque Isle formed by Lake Erie including the old French Fort, containing three thousand & thirty five acres & the usual allowance of six P. Cent for Roads. &c.

To John Lukens Esquire }
Surveyor General

P. John Adlum D.S.

In Testimony, That the above is a copy of the original, remaining on file in the Department of Internal Affairs of Pennsylvania, made conformably to an Act of Assembly, approved the 16th day of February A.D. 1833, I have hereunto set my Hand and caused the Seal of the said Department to be affixed at Harrisburg, the eleventh day of March A.D. 1912.

Henry Aouch
Secretary of Internal Affairs.